

FLOOR PLAN

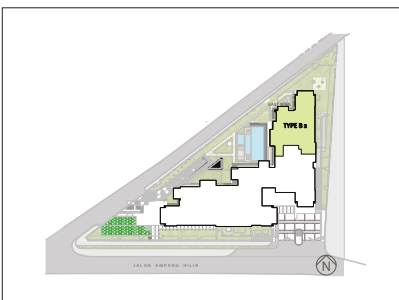

{ TYPE B2 } 4+1 Bedroom Unit 399 m2 (4,293 sq. ft.)

EAST WING



- ① Balcony
- ② Master Bedroom
- ③ Bedroom 2
- ④ Walk-in-wardrobe
- ⑤ Master Bath
- ⑥ Bedroom 3

- ⑦ Bedroom 4/Family/Study
- ⑧ Living
- ⑨ Dining
- ⑩ Powder Room
- ⑪ Store
- ⑫ Dry Kitchen

- ⑬ Wet Kitchen
- ⑭ Private Foyer
- ⑮ Maid
- ⑯ Yard
- ⑰ Guest Lift Lobby